

# Canopy Dimensions & Fittings Guide

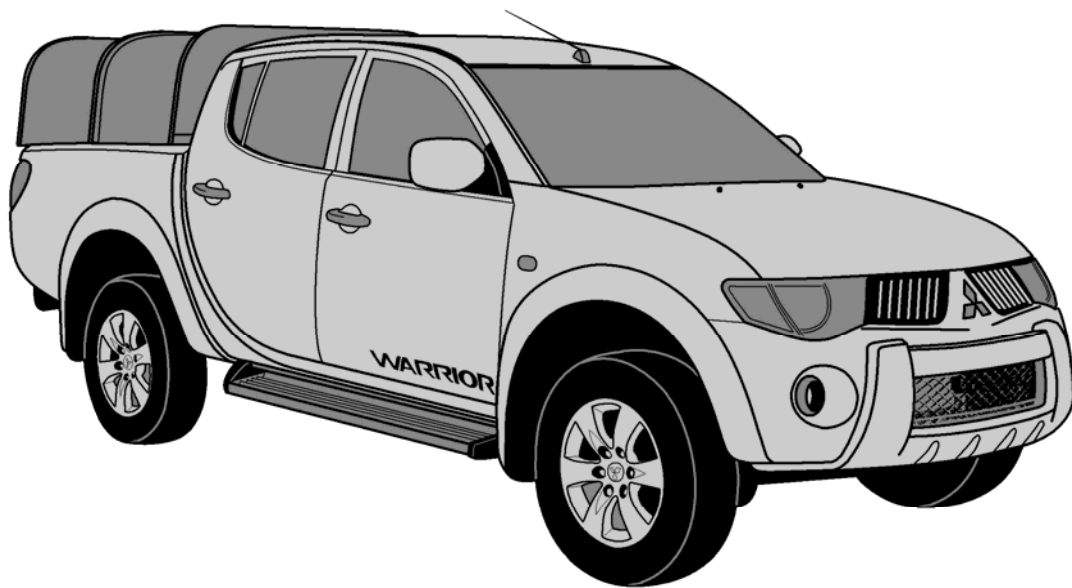

**This document is to be consulted at the time of viewing the vehicle to determine the correct canopy for the customer.**

**Many pick-ups can be imported and their measurements & specifications differ from the UK model (even though they may bear the same model name). It is important that the measurements are verified if there is any doubt.**

**BRITAIN'S LEADING TRAILER MANUFACTURER**



## Canopy fitting guide 2

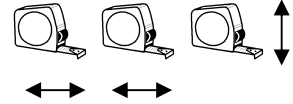
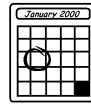
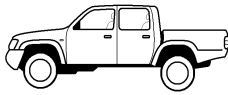

Part code	Manufacturer Model	Production date(s)	Width (Front)	Width (Rear)	Length
<b>Isuzu Rodeo / Chevrolet</b>					
V491	Double cab (& Denver models)	[H/L Brake lamp] Aug 2005 - May 2012	1594	1568	1473
V528	Double cab	Jun 2012 >	1664	1640	1536
V527	Extra cab	Jun 2012 >	1664	1640	1842
V523	Single cab	Jun 2012 >	1680	1680	2336
<b>Greatwall Stead</b>					
V491	Double cab (Stead)	[H/L Brake lamp] Jun 2012 >	1594	1568	1473
<b>John Deere</b>					
V377	Gator HPX (XUV850)		1310	1310	1120
V378	Gator 855	2016>	1435	1435	1130
<b>JCB</b>					
V364	Workmax 800	2012 >	1384	1384	975
V365	Workmax 1000	2012 >	1460	1460	1060
<b>Kawasaki</b>					
V372	Kawasaki 3010 Mule Utility vehicle	2010 >	1372	1372	1168
<b>Kubota</b>					
V375	RTV 900 Utility vehicle	2006 - 2014	1390	1390	1220
V376	RTV X900 Utility vehicle	2015>	1518	1518	1100
<b>Landrover</b>					
V383	Defender 90 SWB	1984 >	1568	1568	1206
V379	Defender 110 LWB Double cab	2000 >	1568	1568	1099
V381	Defender 110 LWB Single cab	1988 >	1568	1568	1937
V380	Defender 110 Hi - Cap	1988 >	1720	1720	2045
V386	Defender 130 Crew Cab	1992 >	1720	1720	1752
<b>Mazda / Ford Ranger</b>					
V398	Mazda 99 / Ford Ranger Double cab	1999 - 2006	1568	1537	1594
V397	Mazda 99 / Ford Ranger Regular cab (Single cab)	1999 - 2006	1568	1537	2337
V399	Mazda 99 / Ford Ranger Super cab (King cab)	1999 - 2006	1562	1537	1816
V389	Mazda BT-50 / Ford Ranger 2007 Single cab	Jan 2007 - Mar 2012	1549	1549	2286
V387	Mazda BT-50 / Ford Ranger 2007 Double cab	Jan 2007 - Mar 2012	1555	1549	1547
V388	Mazda BT-50 / Ford Ranger 2007 Super cab	Jan 2007 - Mar 2012	1555	1549	1778
V484	Ford Ranger 2012 Single cab	Mar 2012 >	1511	1511	2336
V485	Ford Ranger 2012 Super cab	Mar 2012 >	1511	1511	1866
V486	Ford Ranger 2012 Double cab	Mar 2012 >	1511	1511	1575
<b>Mitsubishi</b>					
V406	4 Life/Warrior/Animal/Trojan* - Crew cab (smooth sided)	1999 - 2005	1581	1575	1562
V406W	4 Work - Crew cab (External rail and rope cleats)	1999 - 2005	1562	1562	1562
V404	L200 4x4 Single cab	1997 - 2006	1578	1575	2317
V405	L200 4x4 Crew cab (GL)	1998 - 2006	1581	1575	1562
V409	L200 Club cab	2004 - 2006	1587	1581	1892
V411	L200 2006 model - Double cab [curve to rear sides]	Apr 2006 - Aug 2015	1450	1450	1400
V412	L200 2006 model - Club cab	Oct 2006 - Oct 2009	1645	1594	1850
V413	L200 2006 model - Single cab	Aug 2006 >	1632	1613	2286
V414	L200 2009 model - Double cab Long Bed	Oct 2009 - Aug 2015	1555	1555	1575
V415	L200 2009 model - Club cab	Oct 2009 - Aug 2016	1580	1549	1866
V530	L200 Series 5 - Double cab	Sept 2015 >	1460	1460	1536
V531	L200 Series 5 - Club cab	Sept 2016 >	1460	1460	1900
V532	L200 Series 5 - Single cab	Sept 2016 >	1450	1450	2235

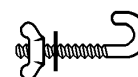
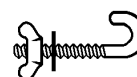
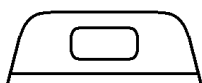

Part code	Canopy side lip fitting	Front panel type	Fittings type	Fittings located
<b>Isuzu Rodeo / Chevrolet</b>				
V491	Outside	Front angle	90mm J Bolt	Inside
V528	Outside	Front angle	90mm J Bolt	Inside
V527	Outside	Front angle	90mm J Bolt	Inside
V523	Outside	Forward facing lip that meshes with rack	70mm J Bolt	Outside
<b>Greatwall Stead</b>				
V491	Outside	Front angle	90mm J Bolt	Inside
<b>John Deere</b>				
V377	Outside	Front Angle (Forward facing)	70mm J Bolt	Outside
V378	Outside	Front Angle (Forward facing)	Clamp	Inside
<b>JCB</b>				
V364	Outside	Front Angle (Forward facing)	60mm J Bolt	Outside
V365	Outside	Front angle	60mm J Bolt	Outside
<b>Kawasaki</b>				
V372	Outside	Front Angle (Forward facing)	60mm J Bolt	Outside
<b>Kubota</b>				
V375	Outside	Front Angle (Forward facing)	60mm J Bolt	Outside
V376	Outside	Double angle (flange up & down)	Clamp	Outside
<b>Landrover</b>				
V383	Outside	Side infill around cab	90mm J Bolt	Inside
V379	Outside	Side infill around cab	90mm J Bolt	Inside
V381	Outside	Side infill around cab	90mm J Bolt	Inside
V380	Outside	Front angle	M8 x 25 Bolt	Outside
V386	Outside	Front angle	M8 x 25 Bolt	Outside
<b>Mazda 99 / Ford Ranger</b>				
V398	Outside	Flat/over the rack	90mm J Bolt	Inside
V397	Outside	Flat/over the rack	90mm J Bolt	Inside
V399	Outside	Flat/over the rack	90mm J Bolt	Inside
V389	Outside	Forward facing lip that meshes with rack	90mm J Bolt	Inside
V387	Outside	Forward facing lip that meshes with rack	90mm J Bolt	Inside
V388	Outside	Forward facing lip that meshes with rack	90mm J Bolt	Inside
V484	Inside	Flat/over the rack	90mm J Bolt	Inside
V485	Inside	Flat/over the rack	90mm J Bolt	Inside
V486	Inside	Flat/over the rack	90mm J Bolt	Inside
<b>Mitsubishi</b>				
V406	Outside	Front angle	90mm J Bolt	Inside
V406w	Outside	Flat/over the rack	90mm J Bolt	Inside *
V404	Outside	Flat/over the rack	60mm J Bolt	Outside
V405	Outside	Flat/over the rack	60mm J Bolt	Outside
V409	Outside	Alloy strip	90mm J Bolt	Inside
V411	Inside	Double angle (flange up & down)	90mm J Bolt	Inside
V412	Outside	Front angle	60mm J Bolt	Inside
V413	Outside	Front alloy strip	60mm J Bolt	Outside
V414	Outside	Double angle (flange up & down)	90mm J Bolt	Inside
V415	Outside	Front angle	90mm J Bolt	Inside
V530	Inside	Front angle	70mm J Bolt	Inside
V531	Inside	Front Angle (Forward facing)	90mm J Bolt	Inside
V532	Inside	Forward facing lip that meshes with rack	90mm J Bolt	Inside

## Canopy fitting guide 4

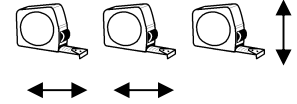
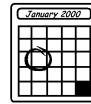
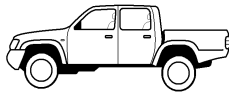

Part code	Manufacturer Model	Production date(s)	Width (Front)	Width (Rear)	Length
<b>Nissan</b>					
V344	D22 Single cab	1998 - 2008	1562	1556	2317
V346	D22 Double cab	1998 - 2008	1568	1568	1473
V345	D22 King cab	1998 - 2008	1568	1568	1943
V347	Navara Double cab - (vehicles without ladder rack)	2001 - 2005	1555	1549	1473
V417	Navara Double cab - (vehicles with ladder rack)	2001 - 2005	1555	1549	1473
V348	Navara King cab - (vehicles without ladder rack)	2001 - 2005	1555	1549	1943
V418	Navara King cab - (vehicles with ladder rack)	2001 - 2005	1555	1549	1943
V419	Navara Double cab D40 Model # (without ladder rack)	2005 - 2015	1490	1490	1560
V421	Navara Double cab D40 Model # (with ladder rack)**	2005 - 2015	1490	1490	1560
V420	Navara King cab D40 model # (without ladder rack)	2005 - 2015	1490	1490	1900
V422	Navara King cab D40 model # (with ladder rack)**	2005 - 2015	1490	1490	1900
V536	Navara Double cab NP300 Model (without ladder rack)	2016>	1490	1490	1595
V537	Navara King cab NP300 Model (without ladder rack)	2016>	1490	1490	1815

# Check vehicle VIN plate, some Navara models have been produced (2005/6) with D22 style rear bodies, if this is the case treat as D22 models.

\*\* Canopies for Navara vehicles with ladder rack are shaped to fit around rack base and will not fit other models.

<b>Polaris</b>					
V367	Ranger 400/500 mid	2012>	1310	1310	877
V368	Ranger 800 full	2012>	1518	1518	997

<b>VW</b>					
V499	Amarok Double cab	2012 - 2016	1511	1511	1535

<b>Toyota</b>					
V467	Toyota Crew cab [Smooth sided with no ladder rack]	1998 - 2005	1556	1549	1422
V465	Toyota Mk4 Single cab (240/250 models)	1998 - 2005	1556	1556	2185
V466	Toyota Mk4 Crew cab (270/280 models)	1998 - 2005	1556	1556	1372
V4691	Toyota MK6 Single cab	Sept 2005 - June 2016	1607	1607	2337
V469	Toyota MK6 Crew cab (Invincible & Vigo No ladder rack)	Sept 2005 - June 2016	1511	1511	1613
V4692	Toyota MK6 Crew cab (HL2 HL3 with ladder rack)	Feb 2006 - June 2016	1511	1511	1547
V4693	Toyota MK6 Extra cab (HL2 HL3 with ladder rack)	April 2007- June 2016	1511	1511	1842
V4694	Toyota MK6 Extra cab (HL2 HL3 No ladder rack)	April 2007 - June 2016	1511	1511	1880
V543	Toyota MK8 Crew Cab (No ladder rack)	July 2016>	1525	1520	1575
V5431	Toyota MK8 Crew Cab (with ladder rack)	July 2016>	1525	1520	1575
V541	Toyota MK8 Extra cab (No ladder rack)	July 2016>	1525	1510	1840
V5411	Toyota MK8 Extra cab (with ladder rack)	July 2016>	1525	1510	1840
V542	Toyota MK8 Single Cab	July 2016>	1730	1730	2340

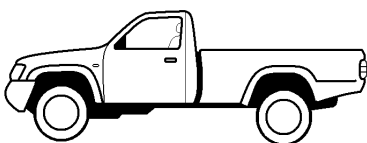

**Single / Regular Cab**

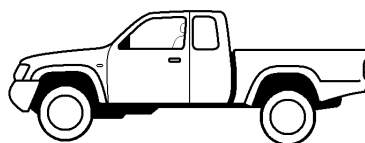

**King / Club / Extra Cab**

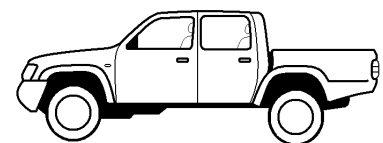

**Double / Twin / Crew Cab**

## Canopy fitting guide 5

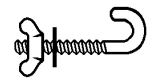
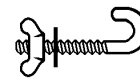
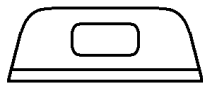

Part code	Canopy side lip fitting	Front panel type	Fittings type	Fittings located
<b>Nissan</b>				
V344	Outside	Flat/over the rack	70mm J Bolt	Outside
V346	Outside	Flat/over the rack	70mm J Bolt	Inside
V345	Outside	Flat/over the rack	70mm J Bolt	Inside
V347	Inside	Front angle	70mm J Bolt	Inside
V417	Inside	Flat/over the rack	70mm J Bolt	Inside
V348	Inside	Front angle	70mm J Bolt	Inside
V418	Inside	Flat/over the rack	70mm J Bolt	Inside
V419	Inside	Front angle	70mm J Bolt	Inside
V421	Inside	Special cutout around ladder rack fixture	70mm J Bolt	Inside
V420	Inside	Front angle	70mm J Bolt	Inside
V422	Inside	Special cutout around ladder rack fixture	70mm J Bolt	Inside
V536	Inside	Front Angle (Forward facing)	70mm J Bolt	Inside
V537	Inside	Front Angle (Forward facing)	70mm J Bolt	Inside

### Polaris

V367	Outside	Front Angle (Forward facing)	60mm J Bolt (spec.)	Outside
V368	Outside	Front Angle (Forward facing)	60mm J Bolt	Outside

### VW

V499	Inside	Front angle	60mm J Bolt	Inside
------	--------	-------------	-------------	--------

### Toyota

V467	Outside	Front angle	90mm J Bolt	Inside
V465	Outside	Forward facing lip that meshes with rack	70mm J Bolt	Outside
V466	Outside	Forward facing lip that meshes with rack	70mm J Bolt	Outside
V4691	Outside	Forward facing lip that meshes with rack	60mm J Bolt	Outside
V469	Inside	Front angle	90mm J Bolt	Inside
V4692	Inside	Forward facing lip that meshes with rack	60mm J Bolt	Inside
V4693	Inside	Forward facing lip that meshes with rack	60mm J Bolt	Inside
V4693	Inside	Front angle	70mm J Bolt	Inside
V543	Inside	Forward facing lip	90mm J Bolt	Inside
V5431	Inside	Forward facing lip that meshes with rack	90mm J Bolt	Inside
V541	Inside	Forward facing lip	90mm J Bolt	Inside
V5411	Inside	Forward facing lip that meshes with rack	90mm J Bolt	Inside
V542	Outside	Forward facing lip that meshes with rack	70mm J Bolt	Outside

## Canopy fitting guide 6

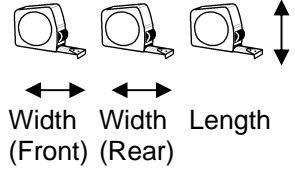
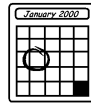
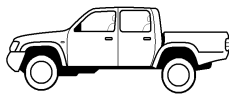

Part code

Manufacturer  
Model

Production date(s)

Width  
(Front)

Width  
(Rear)

Length

### Canopies for trailers

V600 * \$	GD64G (trailers with 4' Ramp )	1986 - 2005	1346	1346	1950
V601 \$	GD64G (trailers Tail Board )	1986 - 2005	1346	1346	1950
V610 * \$	GD84G (trailers with 4' Ramp )	1986 - 2005	1346	1346	2558
V611 \$	GD84G (trailers with tailboard )	1986 - 2005	1346	1346	2558
V612 * \$	GD85G (trailers with 4' Ramp )	1986 - 2006	1657	1657	2635
V613 \$	GD85G (trailers with Tailboard )	1986 - 2006	1657	1657	2635
V600M * \$	GD64M (Metric trailer with 4' Ramp )	2005 >	1365	1365	1950
V601M \$	GD64M (Metric trailer Tail Board )	2005 >	1365	1365	1950
V610M * \$	GD84M (Metric trailer with 4' Ramp )	2005 >	1365	1365	2559
V611M \$	GD84M (Metric trailer with tailboard )	2005 >	1365	1365	2559
V612M * \$	GD85M (Metric trailer with 4' Ramp )	2006 >	1689	1689	2559
V613M \$	GD85M (Metric trailer with Tailboard )	2006 >	1689	1689	2559
V635 * #	P6e (trailer with ramp )	1997 >	1309	1309	2045
V641 #	P6e (trailer with tailboard )	1997 >	1309	1309	2045
V645 **	P6e (trailer with ramp) Livestock Version	1997 >	1309	1309	2045
V660 * #	P7e (trailer with ramp )	2005 >	1309	1309	2275
V661 #	P7e (trailer with tailboard )	2005 >	1309	1309	2275
V665 **	P7e (trailer with ramp) Livestock Version	2005 >	1309	1309	2275
V670 *	P8e (trailer with ramp )	2010 >	1536	1536	2580
V671	P8e (trailer with tailboard )	2010 >	1536	1536	2580

### Notes - Canopies for trailers

\* Canopies for trailers fitted with a ramp are open back construction and cannot be ordered with aluminum door option.

\*\* Refers to a canopy fitted with ramp side gates and Louvre vents in front panel. These canopies are not normally supplied with cross-divisions unless specifically requested (at extra cost)

Please note: cross divisions may need to be added to fully comply with animal transport regulations.

\$ GD Canopies will always be delivered separately from any trailers ordered, and will incur a separate delivery charge.

# These models available with Louvre vents in front panel for those wishing to carry dogs in the trailer (option available only with ramp and meshgate versions marked # in table) suffix V to part code i.e. V660V.

Note: this option is **NOT A LIVESTOCK CANOPY** and therefore will not be fitted with ramp gates or cross division locations etc..

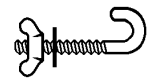
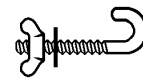
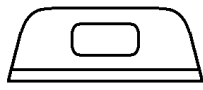

Part code	Canopy side lip fitting	Front panel type	Fittings type	Fittings located
<b>Canopies for trailers</b>				
V600	Outside	Front angle	M8 x 25 Bolt	Through
V601	Outside	Front angle	M8 x 25 Bolt	Through
V610	Outside	Front angle	M8 x 25 Bolt	Through
V611	Outside	Front angle	M8 x 25 Bolt	Through
V612	Outside	Front angle	M8 x 25 Bolt	Through
V613	Outside	Front angle	M8 x 25 Bolt	Through
V600M	Outside	Front angle	M8 x 25 Bolt	Through
V601M	Outside	Front angle	M8 x 25 Bolt	Through
V610M	Outside	Front angle	M8 x 25 Bolt	Through
V611M	Outside	Front angle	M8 x 25 Bolt	Through
V612M	Outside	Front angle	M8 x 25 Bolt	Through
V613M	Outside	Front angle	M8 x 25 Bolt	Through
V635	Outside	Front angle	M8 x 25 Bolt	Through
V641	Outside	Front angle	M8 x 25 Bolt	Through
V645	Outside	Front angle	M8 x 25 Bolt	Through
V660	Outside	Front angle	M8 x 25 Bolt	Through
V661	Outside	Front angle	M8 x 25 Bolt	Through
V665	Outside	Front angle	M8 x 25 Bolt	Through
V670	Outside	Front angle	M8 x 25 Bolt	Through
V671	Outside	Front angle	M8 x 25 Bolt	Through



GD85M fitted with V612M



P6e fitted with V635



## Tailgate options

All the canopies in the table above are fitted with a mesh tailgate as standard, similar to that shown here on the Mitsubishi L200 Double Cab.



If the part code is suffixed with the letter A then the canopy will be supplied with an aluminium rear door and 24" x 12" toughened glass window (see inset), a similar glass panel will be fitted to the front of the canopy in place of the standard mesh screen.

Each Canopy size has a unique V number either with or without a suffix.  
The Suffix meaning is:

- Vxxx** Meshgate with a mesh panel in the front
  - VxxxA** Aluminium door with glass panel (Also has glass panel in front panel\*)
  - VxxxB** Aluminium door solid (Also has solid front panel\*)
  - VxxxC** Meshgate at the back but with a glass panel in front panel\*\*
- Other combinations are available on request

\* Except for those Landrover models which do not have a front panel.

\*\* There will never be a C version for that type of Landrover

## Vehicles with load liners:

In some cases the load liner does not affect the fitting of the canopy, in others it may impair it.

load liners are generally manufactured by a third party and not the vehicle manufacturers themselves, many manufacturers use more than one type on the same model and this has led to a huge variation in thickness and fitting styles being available.

It would be impractical for us to accommodate these within our design, therefore it is the **USERS RESPONSIBILITY** to either modify or remove the load liner to allow for canopy fitting.

If the load liner is left in place it may be necessary to drill some (relatively small) slotted holes in the liner to allow internal fixings to pass through. Some over-lip load liners may need to be trimmed in the width to allow the canopy side rail to sit flat.



## Measuring the vehicle

The vehicle may need to be measured on the inside or outside depending upon the type of side construction employed. The table should be consulted to see if the vehicle is either “inside” or “outside” type and measurements taken as follows:

---

### Outside fitting (where vehicle has square or lipped sides)

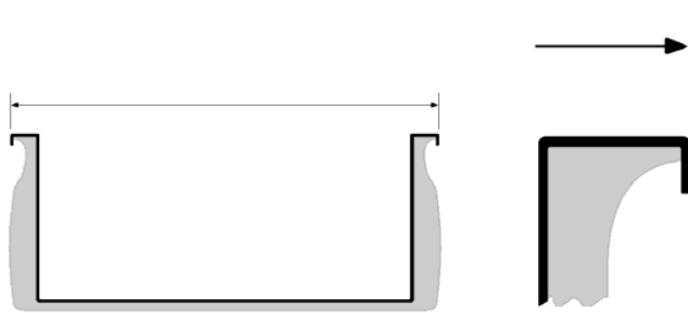

### Outside fitting (where vehicle has very curved sides)

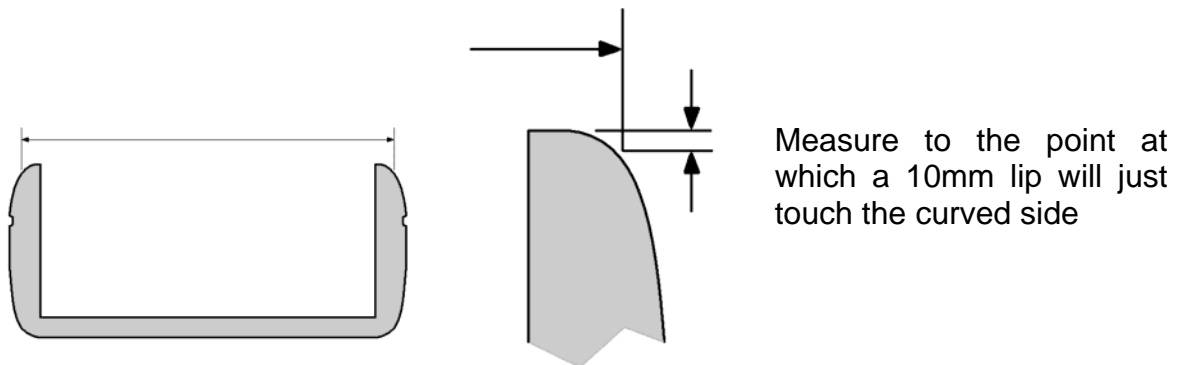

### Inside fitting (where vehicle is too curved to fit outside)

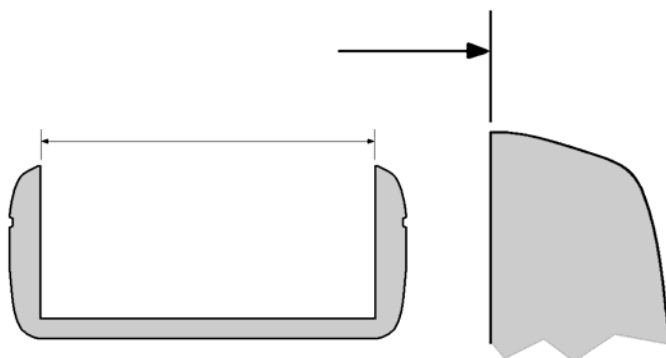

**Front fitting types**

**Front angle**

The canopy front sits on the flat face along the front of the load bed.

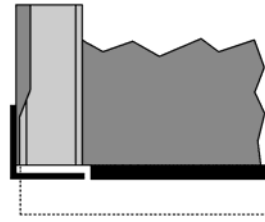

**Alloy Strip**

The canopy front has a lip that sits over the front face of the load bed.

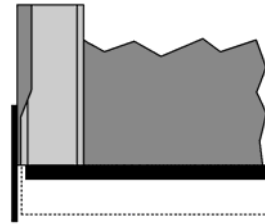

**Lip that meshes with rack**

The front lip or angle faces forward and is notched to fit around the vertical elements of the ladder rack.

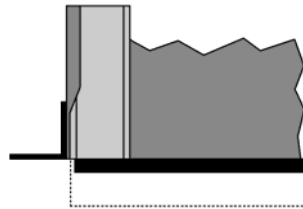

**Flat / Over the rack**

The canopy has a thin front panel that fits between the cab and the ladder rack.

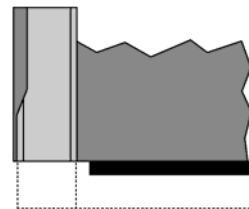

**Side infill around cab (Landrover only)**

The canopy has an open front and thin triangular fillets fitted with a weather seal, these fillets seal against the cab sides or wrap around side windows.

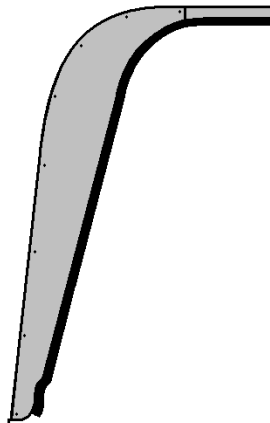

**Special cutout around fixture (Navara only)**

These canopies are cut out to fit around a fixed obstruction, in this case a ladder rack mounting bracket that protrudes beyond the side of the canopy fitting area.

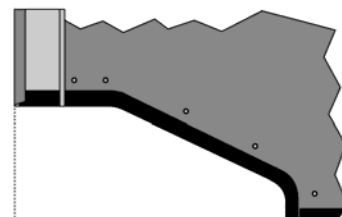

### High Level brake lamps

When fitting a canopy to any vehicle equipped with a cab mounted rear stop light the light **MUST** be permanently disabled.



If this must be disabled in accordance with any statutory or health and safety requirement it must be so disabled in such a way as to comply with all relevant legislation. If in doubt please consult your vehicle manufacturer for the correct method of disabling the lamp. Ifor Williams Trailers Ltd accepts no responsibility whatsoever for loss or damage resulting from any modifications carried out on the vehicle including the disabling of the stop or other lights, obscuring it/them or any damage caused to it/them or the vehicle or loss of

### Optional Extras

#### Canopy lock kit (Alloy Doors only)\* KX0480

\*The lock does not secure the vehicle tailgate



#### Gas Strut Assistor Kit KX0484 (Landrover V379, V383, V381) KX0485 (All other canopies)

These can be fitted to Mesh & Alloy tailgates.



#### Side Door kit KX0487 (this option will not fit every canopy. Please check before ordering)

Door can be fitted left or right hand side (canopy viewed from rear).

As standard the door will be fitted on the right hand side, in the section nearest to the cab.

If the door is required in a different position please state on order.





**Kubota RTV900**  
**Utility vehicle**  
**Fitted with V375**

**Please note:**

Some variations of this vehicle may require the rear road lights re-positioning when canopy is fitted.

## Placing an order

If the vehicle can be successfully identified from the enclosed tables then the standard order form for trailers & canopies can be used. If however the vehicle differs significantly from the figures given, or is known to be a new make or model that is not listed then enquiries should be made with IWT customer care department and an availability date requested.

No promises should be made with regard to price or delivery for a canopy to suit a vehicle that is not shown in these tables or has been ordered with any special / non standard options.

## Tolerance on sizes

Sizes stated in the tables above are our clearance sizes to suit the fitting system employed and may be between 3-5mm over the actual dimension measured. (or 3-5mm under in the case of canopies designed for inside fitting)



Whilst every care is taken to ensure that the information in this guide is correct, no liability can be accepted for any loss, damage or injury caused by any errors in, or omissions from, the information given.

Names of vehicle manufacturers, their model names, codes etc are given for reference only.

Ifor Williams Trailers Ltd., Cynwyd, Corwen, Denbighshire, LL21 0LB, UK