



Leaf Spring Page 40

U-Bolt (Twin) Page 40

U-Bolt plate Page 40

Axles Page 39

Running Gear & Wheel Equipment

Hubs & bearings • Axles • Springs • Suspension components

Contents	Page
Hubs, Bearings and Hub Conversion Kits for current models	37
Hubs & Bearings etc, for older models	38
Axle Beams, Weld Assemblies and Complete Axles, Suspension Units and Spares	39
Springs & Suspension Parts, Rubber Suspension Axle and Axle Mounting Crossmembers	40
Tyres, Compressor & Tyre Gauge, Jack, Axle Stands & Wheelbraces	41
Wheel Assemblies, Tyres, Tyre Changing Ramp and Spare Wheel Bolts	42
Spare Wheel Brackets and Complete Spare Wheel Kits including Spare Wheel Covers	43
Mudguards & Mudflaps	44

Running Gear & Wheel Equipment

Hubs & Bearings

Stake nuts have been used on all trailer models since January 1994

Ifor Williams
Parts®

Page
37

- 1 P1258 Hub cap Grey 76mm. For trailers with bolt on knott brakes and 76mm bearings 1996 onwards.
- 2 F1013Z Stake Nut. Without flange. It is recommended that new nuts are fitted after servicing the brakes.
- 3 F1014 Stake Nut M30. With flange.
- 4 F1951 Circlip. 76mm internal (bearing retainer) circlip - for the current production type bearing.
- 5 P00002 Bearing. Unitized bearing for hubs with a 76mm bore.

HUB KITS

These hub kits suit trailers manufactured from September 1992, complete with the current production bearing fitted. Each hub also comes supplied with the adaptor kit shown below to enable it to be fitted to older models with the round beam axle, Knott brakes and SKF bearings.

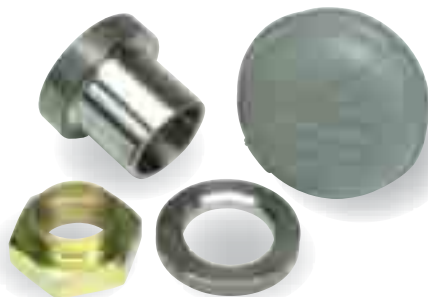

- 6 KS0825 Hub Kit. 200 x 50 brake 4 stud. Contains hub as illustrated, also includes the adaptors and components detailed above.
- 7 KS0826 Hub Kit. 200 x 50 brake 5 stud. Contains hub as illustrated, also includes the adaptors and components detailed above.
- 8 KS0827 Hub Kit. 250 x 40 brake 5 stud. Contains hub as illustrated, also includes the adaptors and components detailed above.

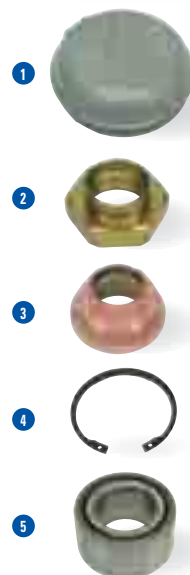

To order see pages 4&5 for distributor details or call 0845 4082 505. Prices available on separate Spares Pricelist



LM146 with headboard, dropsides, meshsides, ramp and prop stands



- 1 KS0755L Brake Drum.** From 20th June 1988 for 6.00x9 wheels. Complete with 2 off bearings P0001 /P0002, oil seal P0004, bearing retaining washer C14679, axle end nut F1099S, grease cap C72253, 5 off wheel stud F1804, 5 off wheel nut F1813, spirol pin F1909S and split pin F1508.
- KS0756 Brake Drum.** From 20th September 1988 for 145R10, 155R13, 175R13 & 6.70x13 wheels Note: HB505R 80637,38,39,40,41 from batch 427; all from batch 437 (P0003 seal) Complete with 2 off bearings P0001 / P0002, oil seal P0004, bearing retaining washer C14679, axle end nut F1099S, grease cap C72253, 4 off wheel stud F1801, 5 off wheel nut F1811, spirol pin F1909S and split pin F1508.
- 2 KS0757L Brake Drum.** From 15th February 1988. DP120G, LL106G, LL126G, LL146G (225R10 wheel)(DP120G batch 291, LL batch 286) Complete with 2 off bearings P0001 /P0002, oil seal P0004, bearing retaining washer C14679, axle end nut F1099S, grease cap C72253, 5 off wheel stud F1804, 4 off wheel nut F1813, spirol pin F1909S and split pin F1508.
- 3 P0001 Bearing Cup.** All trailers to September 1992 (HB401 until April 1993) requires bearing P0002.
- 4 P0002 Bearing Cone.** All trailers to September 1992 (HB401 until April 1993) requires cone P0001.
- P0081 Oilseal.** Most models (pre 1978).
- P0003 Oilseal.** 43 x 75 x 10mm.
- P0004 Oilseal.** 55 x 75 x 10mm.

- F1811 Wheel Nut.** M12 x 1.5mm pitch (1976-1992).
- F1813 Wheel Nut.** M16 x 1.5mm pitch (1976-1992).
- 5 P1250 Hub Cap Black 75mm.** For trailers with weld on knott brakes and 75mm bearings 1992-1996.
- 6 C72253 Hub Cap.** For trailers with Al-Ko brakes and taper roller bearings 1981-1992.
- 7 F1098S Axle End Nut.** 3/4" BSF six slotted axle end nut for early trailers with solid beam axles.
- 8 F1099S Axle End Nut.** 3/4" BSF ten slotted axle end nut for later trailers with solid beam axles.
- 9 F1508 Split Pin.** 1-1/2" long x 5/32" diameter.
- 10 F1502SS Split Pin.** 1 long x 5/32" diameter stainless steel.
- 11 C14679 Washer.** Bearing retaining washer for older round section axles.



Running Gear & Wheel Equipment

Axle & Suspension

Ifor Williams
Parts®

Page
39

- 1 **P0591** **Suspension Unit.** For 500Kg GVW trailers, complete with 4" PCD hubs, as fitted to P6e (before 1997).
- 2 **P0593** **Suspension Unit.** For 750Kg GVW trailers, complete with 4" PCD hubs, as fitted to P6e (before 1997).
- 3 **P0591/HUB** **Hub Assembly.** For P6e trailers fitted with black suspension units, complete with bearings and seal.
- 4 **P0591/IB** **Inner Bearing.** For P6e trailers fitted with black suspension units, complete with cone and seal.
- 5 **P0591/OB** **Outer Bearing.** For P6e trailers fitted with black suspension units, complete with cone and seal.
- 6 **P0591/N** **Wheel Nut.** 3/8" UNF Spherical seat for P6e trailers with black suspension units.
- 7 **P0591/CAP** **Grease Cap.** For P6e trailers fitted with black suspension units.
- 8 **P0591/S** **Wheel Stud.** For P6e trailers fitted with black suspension units (3/8 UNF).



Complete Axle Assy Number	Models This Axle Is Fitted To	Weld Assembly Number	Spring Centres	Length Over Hub Faces	Number Of Wheelbolts
AS 6401	Eurolight Unbraked	AS4007	757	1122	4
AS 6402	HB510R, HB511, GD6 Metric	AS0381	1770	2110	4
AS 6403	HB505R, HB505RL, HB506	AS0382	1642	1984	4
AS 6404	TA5G (8' 10' 12') GD85G, GD105G, GD125G	AS0383	1542	1924	4
AS 6406	LT106G, LT126G, LT146G, LT146G/B	AS0384	1450	1828	4
AS 6407	HB401	AS0386	1227	1610	4
AS 6408	LT105G, LT125G	AS0387	1146	1520	4
AS 6409	TT85G	AS0388	1110	1460	4
AS 6410	LT85G	AS0389	1045	1387	4
AS 6411	TA5G 10' & 12', GD105G, GD125G (5 Bolt) 200x50	AS0390	1542	1924	5
AS 6412	Brake Assembly	AS0391	1224	1610	5
AS 6413	GD64G, GD84G	AS0387	1146	1520	5
AS 6414	LM105G, LM125G	AS0389	1045	1387	5
AS 6415	LM85G	AS0390	1530	1924	4
AS 6416	BV85G, BV105G	AS0391	1224	1610	4
AS 6417	P6G, P8G, GD64G, GD84G, GD84GTA, GP74GTA, BV84G	AS0392	1755	2100	4
AS 6418	LT1*7	AS0393	1250	1610	4
AS 6419	GP84GTA (Obsolete Plant Trailer), GX84 & GD4 Metric (4 bolt)	AS0384	1450	1828	5
AS 6420	LM1*6/DP/CT166 Tri-Axle	AS0392	1755	2100	5
AS 6421	LM1*7/CT167 Tri-Axle (2.3M)	AS0398	1770	2150	5
AS 6422	TA510G3-14 Tri-Axle	AS0400	1770	2150	5
AS 6423	TA510 (10', 12'), GD106G, GD126G, BV6 (16" wheels)	AS0401	1770	2110	5
AS 6424	GD106, GD126, GP106GM, BV106G, BV126G (UK), GX106, GX106N, GX126, GP106 & GP126 (12" wheels)	AS0402	1450	1828	5
AS 6425	DP120, LM106G, LM126G, LM146G & GB, LM166G & GB, CT166G	AS0403	1755	2150	5
AS 6426	LM 7' 6" (OLD MODELS)	AS0404	1146	1520	5
AS 6427	LM105GHD, LM125GHD, TT105G	AS0405	1045	1387	5
AS 6428	LM85GHD	AS0406	1755	2100	5
AS 6429	LM/LT/CT167G 2.3M, CT177G	AS0409	1542	1924	5
AS 6430	TA5GHD (5 Bolt) 250x40 Brake Assembly	AS0417	1770	2175	5
AS 6431	GP106 & GP126 (16" wheels)	AS0408	1575	1935	5
AS 6432	GX105HD, GX125HD, GD5 Metric (16 in) wheels	AS0379	1610	1975	5
AS 6433	CT115	AS0381	1770	2110	5
AS 6434	GP126 & GP146 Tri-Axle (12" wheels)	AS0395	1575	1935	4
AS 6435	GD5 Metric GX85, GX105	AS0397	1770	2135	5
AS 6436	CT136, CT136SA	AS0399	1770	2175	5
AS 6437	GP126 & GP146 Tri-Axle (16" wheels)	AS0411	757	1147	4
AS 6438	Eurolight 1.2m	AS0412	1032	1407	4
AS 6439	Eurolight 1.5m	AS0393	1250	1610	5
AS 6440	GD4 Metric (6.50R16C, 175/75R16) Wheels	AS0395	1575	1935	5
AS 6441	GD5 Single Axle Metric (175/75R16) Wheels	AS0423	1161	1511	4
AS 6442	GH64, GH94	AS0340	1240	1590	4
AS 6443	GH94BT, GH94 + 3	AS0413	1275	1610	4
AS 6444	HB403	AS0341	1556	1905	5
AS 6445	GH1054BT				

These are distributor delivery only due to weight and size.

To order see pages 4&5 for distributor details or call 0845 4082 505. Prices available on separate Spares Pricelist

Running Gear & Wheel Equipment
Axle & Suspension

NEW TYPE



- 1 P12081 **Spring Eye Bush.** Used in parabolic springs Type C90003 & C90004.
 - 2 P1208 **Bush.** Used in parabolic springs Type C90001 & C90002.
 - 3 C20340 **Spacer Tube.** For spring eye bush in Parabolic springs C90001 and C90002 (will not fit C90003 or C90004).
 - 4 C90003 **Parabolic Spring.** Mono leaf parabolic road spring (current production type).*
 - 5 C90004 **Parabolic Spring.** Twin leaf parabolic road spring (current production type).*
 - 6 F0417 **Centre Bolt.** M8 x 40 Spring centre bolt. Bolts the two leaf spring together.
 - 7 C31270 **Clamp Plate.** Used to secure U-Bolts to axle and springs (2 per axle).
 - 8 C00141 **U-Bolt.** Holds the axle and roadsprings together - 4 per axle 120mm long (single leaf springs).
 - 9 C00148 **U-Bolt.** Holds the axle and roadsprings together - 4 per axle 130mm long (Two leaf springs).
 - 10 C70340 **Spring Retainer Bush.** 50mm Used at the flat end of the mono leaf spring to prevent spring movement (where there is no second spring eye present).
 - 11 C70341 **Spring Retainer Bush.** 42mm Used at the flat end of the twin leaf spring to prevent spring movement (where there is no second spring eye present).
 - 12 C80315 **Bump Stop.** Used on all trailers with Parabolic springs from January 1994.
 - F0374ZPK **Bolt M12 x 80 Hex High Tensile.** Used to secure the leaf spring through the eye of the bush. Pack Qty 10.
 - F0378ZPK **Bolt M12 x 100 Hex High Tensile.** Used to secure the leaf spring through the eye of the bush. Pack Qty 10.
 - F1059ZPK **Nut M12 Nyloc.** Used to secure C00141 & C00148 U-Bolts. Pack Qty 10
- * It is recommended that these springs are changed in axle sets only.

OLD TYPE

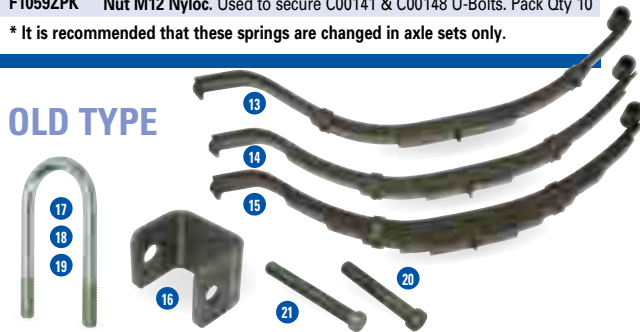

- 13 P0019 **4 Leaf Spring.** This type of roadspring was used on various models until January 1994.
- 14 P0020 **5 Leaf Spring.** This type of roadspring was used on various models until January 1994.
- 15 P0022 **7 Leaf Spring.** This type of roadspring was used on various models until January 1994.
- 16 C10011 **Shackle Bracket.** Weld on component for trailers with 4,5 or 7 leaf springs.
- 17 C00145 **U-Bolt.** Holds the axle and roadsprings together - 4 per axle (7 leaf springs Post March 1990).
- 18 C00146 **U-Bolt.** Holds the axle and roadsprings together - 4 per axle (5 leaf springs Post March 1990).
- 19 C00147 **U-Bolt.** Holds the axle and roadsprings together - 4 per axle (4 leaf springs Post March 1990).
- F1078ZCPK **Nylon Nut ½" UNF.** To fit C00145, C00146 & C00147 U-Bolts. Pack qty 10
- 20 F0418 **Centre Bolt.** 5/16 BSF x 2" Spring centre bolt.
- 21 F0419 **Centre Bolt.** 5/16 BSF x 2-1/2" Spring centre bolt.
- F0464ZPK **Bolt 5/8 unc x 3 3/4 Hex Head.** Used to secure the 4,5 & 7 leaf spring. Pack Qty 8.
- F1081ZPK **Nut 5/8 unc.** Nylon Pack Qty 10.

BV64e, P5, P6e, P7e & P8e



- P05915 **Suspension Axle.** 500Kg GVW Rubber suspension axle complete with hubs (100mm PCD) as fitted to P5 models.
- 22 P05920 **Suspension Axle.** 500Kg GVW Rubber suspension axle complete with hubs (100mm PCD) as fitted to P6e & BV64e with 10" tyres.
- 23 P05930 **Suspension Axle.** 750Kg GVW Rubber suspension axle complete with hubs (100mm PCD) as fitted to P6e & P7e with flotation wheels.
- P05940 **Suspension Axle.** 500kg GVW Rubber suspension axle complete with hubs (100mm PCD) as fitted to P6E & P7E with 13" wheels.
- P05945 **Suspension Axle.** 1000kg GVW Rubber suspension axle complete with hubs. (100mm PCD) as fitted to the P8E with 13" and flotation wheels.
- P05931 **Hub Overhaul Kit.** For the full suspension axle fitted to P6e models (1997 onwards) P5, P7E & P8E overhauls one hub. Complete with bearing, seal, clip, hub cap and axle end nut.
- 24 P05931/HUB **Hub.** For the full suspension axle fitted to P6e models (1997 onwards), P5, P7E & P8E.
- 25 P05931/BE **Bearing.** For the full suspension axle fitted to P6e models (1997 onwards), P5, P7E & P8E.
- 26 P05931/C **Circlip.** For the full suspension axle fitted to P6e models (1997 onwards). Also fitted to P5, P7E & P8E.
- 27 P05931/S **Seal.** For the full suspension axle fitted to P6e models. 56mm OD x 44mm ID x 5mm.
- 28 P05931/S2 **Seal.** For the full suspension axle fitted to P6e models. 64mm OD x 44mm ID x 5mm. Also fitted to P5, P7E & P8E.
- 29 P05931/AN **Axle End Nut.** For the full suspension axle fitted to P6e models (1997 onwards). Also fitted to P5, P7E & P8E.
- 30 P05931/HC **Hub Cap.** For the full suspension axle fitted to P6e models. Fits 52mm hole.
- 31 P05931/HC2 **Hub Cap.** For the full suspension axle fitted to P6e models. Fits 64mm hole. P5, P7E & P8E.

Running Gear & Wheel Equipment

Tyres & Accessories

Ifor Williams
Parts®

Page
41



		Load/Speed Indices
1	P0815T Tyre. 145R10C 8pr Avon.	84/82N
	P0879T Tyre. 175/75R16.	104N
	P0817T Tyre. 155R13.	78S
2	P0888T Tyre. 650/16 10pr.	108/107P or N
3	P0841T Tyre. 165R13C 8pr.	96N (FRT)
4	P0878T Tyre. 155/70R12C 'Max Miller'.	104/101N
5	P0875T Tyre. 185/60R12 GT.	104/101N
	P0873 Tyre. 195/50R13 'Max-Miller'.	104/101N
	P0876T Tyre. 195/55 R10 TL 10PR.	98N
	P0889T Tyre. 195/60 R12.	104N
	P0849SV Steel Bodied Valve. Used for 195/50R13, 185/60R12, 195/60R12, 155/60R12 & 195/55R10TL	
6	KX0835 Wheel Trim Set. To fit 13" wheels, supplied in a set of 4. Style of trim may vary from illustration.	
7	P1256 Wheel Brace. Supplied with all current horseboxes.	
8	B0019 Wheel Nut Wrench. 4 headed wrench sizes 17, 19, 21 and 22.	

9	F1830ZPK Wheel Bolt. M12 x 1.5mm pitch 30mm long, 19mm A/F head. Pack of 4
10	F1835ZPK Wheel Bolt. M14 x 1.5mm pitch 27mm long, 19mm A/F head. Pack of 5
11	KX9802 Locking Wheel Bolt Kit. M12 x 1.5 pitch with uniquely coded adapter and spider wheel wrench.
	B0054 Trailer-Aid Ramp - Black. Simplifies wheel changing on twin axle trailers.
12	B0055 Trailer-Aid Ramp - Yellow. Simplifies wheel changing on twin axle trailers.
13	B0013 Wheel Chocks. Pair of basic black plastic wheel chocks. Holder not supplied.
14	KX0240 Wheel Chocks. Pair of lightweight wheel chocks with snap fit holder for fixing to trailer.

To order see pages 4&5 for distributor details or call 0845 4082 505. Prices available on separate Spares Pricelist



1	P0815	Wheel Assembly. 145R10 8PR VAN.	84/82N
2	P0841	Wheel Assembly. 165R13C 8PR.	96N (FRT)
3	P0845	Wheel Assembly. 145R10 /HG58 68S. Used for P6E with suspension units fitted.	
4	P0835	Wheel Assembly. 145/80B10 Used on the P5, P6E, BV64E & the Unbraked Eurolight range. 74N.	
	P0851	Wheel Assembly. 185/70R13.	106/104N
	P0852	Wheel Assembly. 155R13.	78S/T
	P0853	Wheel Assembly. 175R13.	86S/T
5	P0867	Wheel Assembly. Flotation tyre 100mm PCD 77M as used on P6E, P7E & P8E.	
6	P0868	Wheel Assembly. Flotation tyre mounted on 100mm / 4 inch PCD Wheel centre for P6E with suspension units fitted.	
7	P0872	Wheel Assembly. 195/50R13C 8PR.	104/101N
8	P0878	Wheel Assembly. 155/70R12 155/70R12C MAX-MILER.	104/101N
9	P0879	Wheel Assembly. 175/75R16C Max-Miler.	
9	P0875	Wheel Assembly. 185/60R12 (GT).	104/101N
10	P0876	Wheel Assembly. 195/55R10C 98N. Used on the GH range of trailers.	
11	P0877	Wheel Assembly. 155/70R12C 100J 5.5 x 12 as used on the CT115, CT136 & CT177.	104N
12	P0888	Wheel Assembly. 6.50R16 10PR LT.	
13	P08891	Wheel Assembly. 195/60R12C 6J 104N.	

	P0833	Wheel Assembly. 145/70R13 – 84N. Fitted to the LT range. 84N	
	P0834	Wheel Assembly. 145/70R13 camac, fitted to the P6E, P7E & P8E. 78N.	78N
14	P0804	Wheel Centre. 3.5 x 10 HG217 H/Duty. To suit P0815 145R10 8PR VAN	
15	P0805	Wheel Centre. 4-1/2 J-13 HG601, Styled. To suit P0841 165R13 & P0833 145/70R13 – 84N.	
16	P0808	Wheel Centre. 500F x 16in. To suit P0879 175/75R16 & P0888 6.50R16	
17	P0810	Wheel Centre. 3.50 x 10 Vlukon for P6E with suspension units fitted.	
18	P0812	Wheel Centre. 6.00 x 10 Vlukon for flotation tyres, used for P6E with suspension units fitted.	
19	P0820	Wheel Centre. 6J-13 H2 5ST. To suit P0872 195/50R13C.	
	P0878C	Wheel Centre. To suit 155/70R12C MAX-MILER.	
20	P0865	Wheel Centre. 6.00 x 10 100mm PCD for P7E & P6E with flotation tyres and a one piece axle.	
21	P0875C	Wheel Centre. 5.50 x 12" 5/6.5" Silver. To fit 185/60R12, 195/60R12 and P0877 Car Transporter wheel assemblies.	
	P08891C	Wheel Centre. To suit 195/60R12 6J.	
	P0876C	Wheel Centre. 6.00 x 10" 4/5.5" Silver. To suit 195/55R10C.	
22	P0864	Wheel Centre. 3.5 x 10 100mm PCD For P6E with one piece axle fitted.	
23	P0841AL	Alloy Wheel. With 165R13 tyre fitted, suitable for the HB401, HB403, HB505, HB506, HB510 & HB511. Priced individually.	
	P0841ALCC	Alloy Wheel Centre Cap.	

Running Gear & Wheel Equipment

Spare Wheel Options

Ifor Williams
Parts®

Page
43

To order see pages 4&5 for distributor details or call 0845 4082 505. Prices available on separate Spares Pricelist



SPARE WHEEL BRACKETS

- 1 **AS0013 General Purpose Spare Wheel Bracket.** Used on older livestock and Box van trailers.
- AS5026 Spare Wheel Bracket.** Used on the TT85G.
- 2 **AS5100 Spare Wheel Bracket.** Used on the older GD range and the current TT105G & TT126G.
- AS5106 Spare Wheel Bracket.** As fitted to front of P6e & P7e models with flotation tyres.
- AS5107 Spare Wheel Bracket.** As fitted to front of P5, P6 & P7e models with 10" or 13" roadwheels.
- 3 **AS5539 Spare Wheel Bracket.** Offset spare wheel bracket for LT/LM models which have a winch fitted over the standard spare wheel position.
- C00371 Spare Wheel Bracket.** Spare wheel support bracket for the GX trailer range.
- 4 **C10770 Spare Wheel Bracket.** Compatible with 13" & 16" wheels. Used on the current Boxvan, GD range, TA5G, TA510G, HB510XL & HB610.
- C12223 Spare Wheel Bracket.** Drawbar mounted, used on the current DP range.
- 5 **KX4949 Spare Wheel Bracket.** Chassis mounted, used on the current DP range.
- 6 **KX9978 Spare Wheel Bracket.** Used on the HB401, HB505 & HB510.

SPARE WHEEL BRACKET FITTINGS

- C04237 Lower Support Bracket.** Used on the current TA5G, TA510G, HB510XL & HB610.
- C09803 Studding.** M16 x 165mm.
- C09804 Studding.** M16 x 115mm.
- C11272 Spare Wheel Clamp.** Used to secure spare wheel bracket to trailer side channels (also required: M12 setscrew).
- 7 **C15841 Spare Wheel Clamp.** Used with studding to secure spare wheel.
- F1067ZPK Nut M16 Hex.** Compatible with studding. Pack Qty 10.
- 8 **KX0795 Lockable Spare Wheel Carrier.** Used on the HB403, HB506 & HB511. Allows a padlock to be fitted (not included).
- 9 **P0885-SVR Spare Wheel Cover.** Silver rigid cover printed with the Ifor Williams logo. Suitable for the complete Horsebox range.

SPARE WHEEL KITS

Wheel assembly & bracket included

- KX0243 Spare Wheel Kit.** CT136 & CT115.
- KX35312 Spare Wheel Kit.** GH94 (195/55R10TL).
- KX35318 Spare Wheel Kit.** GH94BT (165R13).
- KX35319 Spare Wheel Kit.** GH94+3 (195/55R10TL).
- KX35320 Spare Wheel Kit.** GH1054BT (185/70R13).

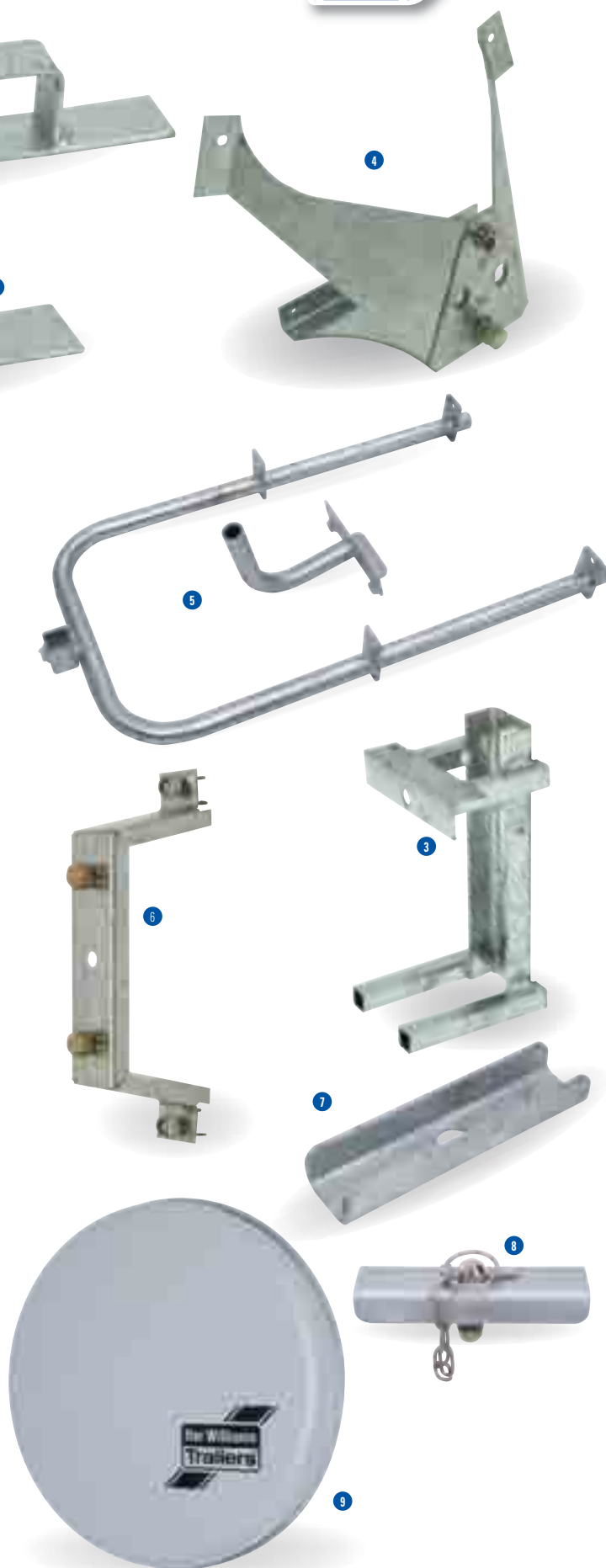

Running Gear & Wheel Equipment

Mudguards & Mudflaps

To order see pages 4&5 for distributor details or call 0845 4082 505. Prices available on separate Spares Pricelist



- 1 CP00321 **Mudguard Twin Arch Section.** Used on the HB403, HB506 & HB511. (1 pair)
- 2 CP00322 **Mudguard Inner Section.** Used on the HB403, HB506 & HB511. (1 pair)
- 3 C71730 **Mudguard Single.** Used on the CT115, CT136 & CT136SA, P5E & P6E with 10" wheels fitted. (1 pair)
- 4 C71733 **Mudguard Single.** Used on the Eurolight range and The P6E, P7E & P8E with 13" wheels. (1 pair)
- 5 P0605 **Mudguard Single.** Used on the P6E, P7E & P8E with wheels fitted. (1 pair)
- 6 P0608 **Mudguard Single.** Used on the TT126G. (1 pair)
- 7 P0610 **Mudguard Single.** Used on the TA5G 12', TA5G 12' - 4ft h'room, TA510G 12' & TA510G 14', HB510XL 10' GD 4 & 5 with 16" wheels. (1 pair)
- 8 P0612 **Mudguard Tandem.** Length 1500mm. Used on the BV85G, BV105G & BV125G, GD84 & 85 Twin axle with 13" wheels, TA5G 8' & TA5G 8' 4ft h'room. (1 pair)
- P0613 **Mudguard Tandem.** Length 1540mm. Used on the GP 6, TT105G, TA5G 10' & TA5G 10' 4ft h'room, BV106G & BV126G 12" & 13" wheels GD105, GD125, GD106 & GD126. (1 pair)
- P0614 **Tandem Mudguard.** Length 1750mm. Used on the TA5G 10' with 16" Wheels & TA510G 10', GD105 & GD125 with 16" wheels, BV106 & BV126 with 16" wheels, HB510XL & HB610. (1 pair)
- P0619 **Tandem Mudguard.** Length 1500mm. Used on the HB401, HB505 & HB510. (1 pair)
- P0621 **Tri-Axle Mudguard.** Used on the TA510G 14' Tri-Axle. (1 pair)
- 9 C70597 **Mudflap.** Used on the GX84, GX106N & GX125 (Sold individually)
- C70595 **Mudflap.** Used on the GX106 & GX126 (Sold individually)
- KS3990 **Mudflap Kit.** For TT85G Models, includes hinges & fixing kit.
- 10 KX0826 **Mudflap Kit.** For HB403, HB506 & HB511 models.
- 11 C80370 **Mudflap.** For the GH & GP models. Sold individually.
- 12 C80737 **Mudflap.** For the LT/LM/CT models with IWT logo Sold individually
- 13 C00473 **Mudguard Bracket.** Centre for Tandem mudguards
- 14 C00476 **Mudguard Bracket.** Front and rear for Tandem Mudguards with 13" wheels fitted.
- 15 C00477 **Mudguard Bracket.** Front and rear for Tandem Mudguards with 16" wheels fitted.
- 16 C14244 **Mudguard Inspection Step.** Fitted between the Single mudguards on livestock trailers.

